

Wire Roll File

Assembly Instructions

for MODEL RF619 / RF620

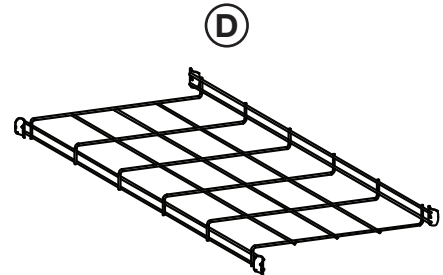
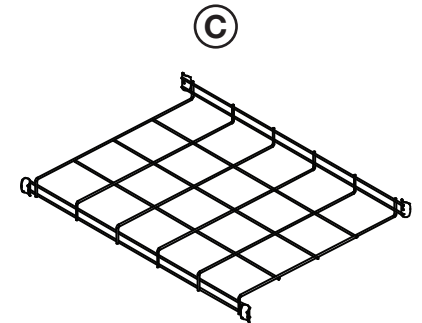
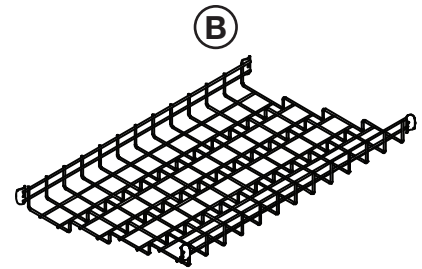
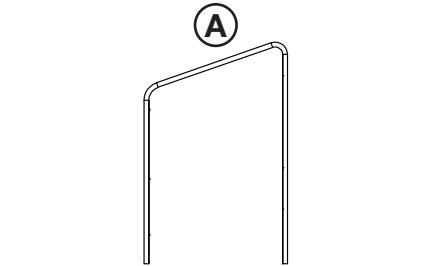
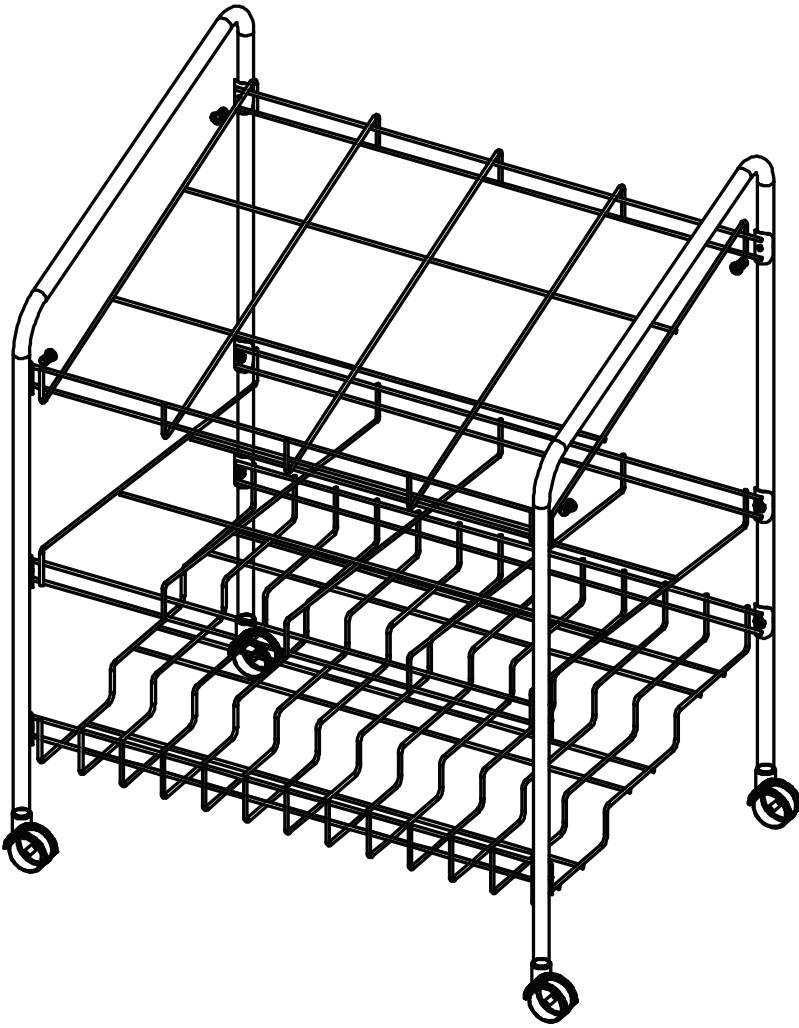

PARTS LIST

Item	Description	QTY.
A	Side Frame	2
B	Stepped Base net	1
C	Middle net	1
D	Top net	1
E	Wheel	4
F	M6 Cross Screw	12

Tools required for assembly: **Phillips screwdriver**

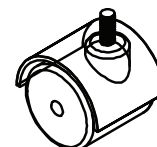

Wire Roll File

Assembly Instructions

for MODEL RF619 / RF620

1. Screw part (E) wheels into part (A) Side Frames.

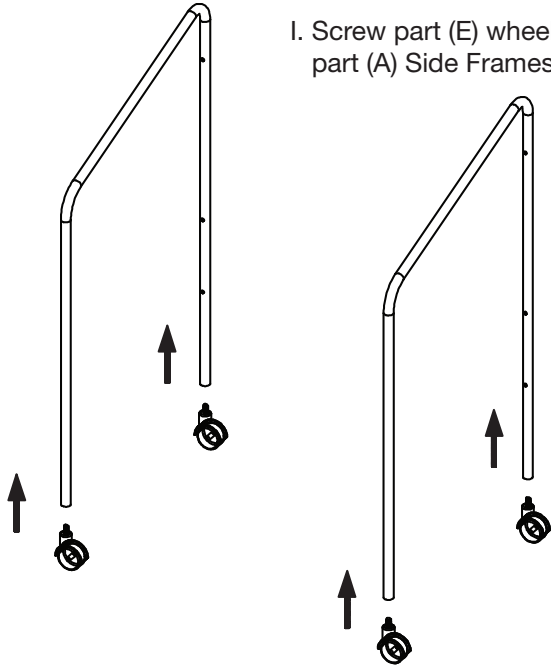

3. Screw part (C) middle net into the second hole from the top of part (A) on all sides.



2. Screw part (D) Top net into the part (A) side Frame's, screwing the low front of the net into the top holes at the front side of the frame, and the high back of the net into the top holes at the back side of the frame.

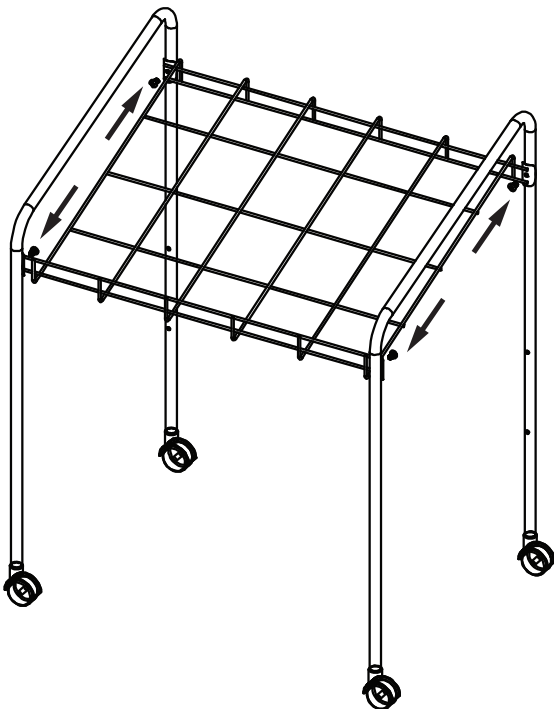

4. Screw part (B) stepped Base net into the third hole from the top of part (A) on all sides.

